

# Válvula Borboleta

## Componentes

- 01 - Corpo
- 02 - Vedação
- 03 - Eixo
- 04 - Corpo
- 05 - Corpo
- 06 - Haste
- 07 - Retenção
- 08 - Porcas
- 09 - Parafusos

## Vedações

- EPDM
- Silicone
- Viton

## Acabamento de Superfície

PI/PE: Ra < 0,80 µm (32 µin)  
Polimento Mecânico

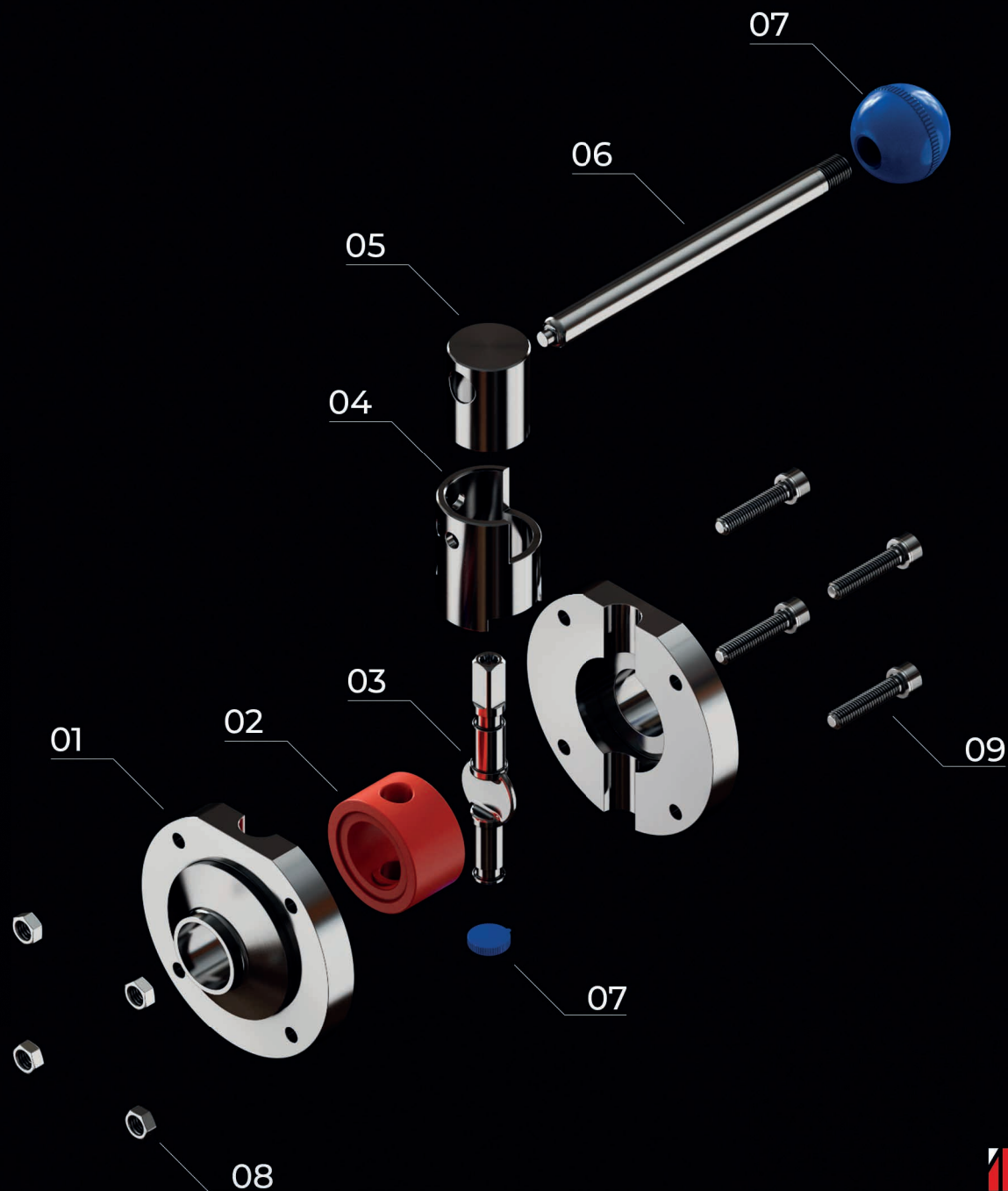

# Válvula Borboleta

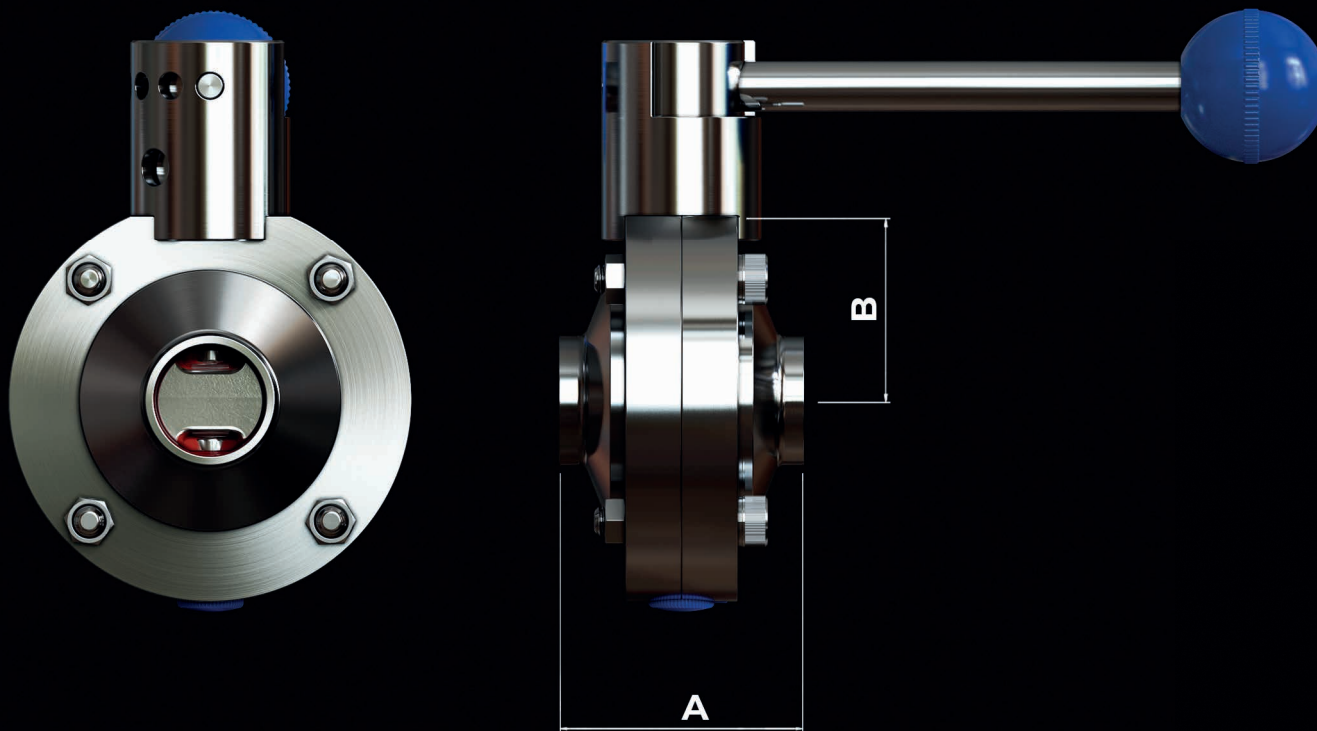

$\emptyset$	A	B
1"	48,0	39,5
1.1/2"	50,0	43,0
2"	52,0	50,0
2.1/2"	54,0	57,5
3"	54,0	64,0
4"	64,0	77,0
6"	86,0	109,0